

Burkett & Wong - Structural Engineer
Thomas Ricca Associates - Food Service Consultant
Kloppenber & Co. - Restaurant Supply Contractor
Jerry Kugler Associates - Lighting Consultant
Harper Construction: Robert Canuso, Project Supervisor - General Contractor

Aventine Partnership - Owner
Deborah Natsios - Architect
Southland - HVAC
Wormwald - Fire Safety
Dynalectric: Dunn, Lee, Smith & Klein - Electrical Engineer

1990

RESTAURANT
at the AVENTINE

Aventine Partners
La Jolla, CA

1,500 sq.ft., 135 seat restaurant at the
Aventine, a \$150million, mixed-use project
in La Jolla, California, designed by Michael
Graves. Mixed-use project is centered on the
Hyatt Regency hotel.

*Godfrey-June, Jean. "A Thinking Man's
Dinner." Contract Design 10/91: 48-51*

*Eng, Rick. "Sensual Geometry."
DesignersWest 10/90: 52-55*

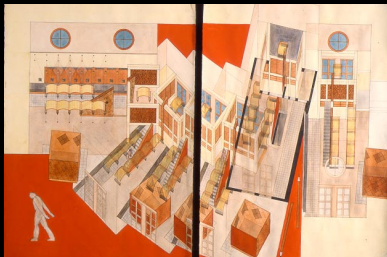

DESIGNERSWEST
THE MAGAZINE OF INTERIOR DESIGN EXCELLENCE

LIGHTING

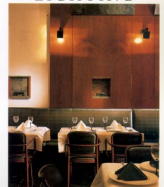

RESTAURANTS